

"PCR" SERIES	Technical details
	<ul style="list-style-type: none"> • The doors from the "PCR" series have a temperature rise core designed to limit temperature rise on the non exposed door face, thus allowing the people being in the building to safely evacuate the area; • Available with fire resistance, either 1 1/2 hours (90 min.) or 3 hours (180 min.); • The doors are provided with a label indicating the degree of temperature and duration of fire resistance: 250°F for 30 min. or 450°F for 60 min. (250°C for 60 min.); • Essentially built as the "PS" series the "PCR" doors have a mineral fibre core approved by WHI laboratory. This core is laminated to the door faces by a polyurethane base adhesive; • Glass opening: The maximum size allowed in a 1 1/2 hour (90 min.) fire rated PCR door is 645 sq. cm (100 sq. in.) and only one opening allowed per door. A PCR door with a 3-hour (180 min.) fire rating has no glass opening allowed; • A ventilation grille is not permitted in a PCR door.

STEEL DOORS	Options
	<ul style="list-style-type: none"> • All of these designs are also available in Z275 (G90) galvanized steel; • Vinyl caps installed at the top of the doors for exterior openings; • Steel caps installed at the top and the bottom of the doors; • Mechanical lock seams welded at every 152 mm (6") center to center grinded, filled with metallic paste, ground smooth and primed; • Other hardware preparations are also available upon request.

Glazed openings

MAXIMUM LIMITATIONS OF GLAZED OPENINGS IN FIRE DOORS

- 180 min. fire rated door (no glazing allowed)
- 90 min. fire rated door (max. 645 cm² (100 in²) per door)
- 45 min. fire rated door (max. 8361 cm² (1296 in²) per opening and max. dimensions 54")
- Several designs of doors with glazed openings are available and Métalec offers you different trim kits:
 "NL" - "LNL" - "DNL" - "HG" - "FGWR" - "VL" - "CGL" - "FG" - "JDS" - "OG" type
 (See Glazed opening types hereafter)

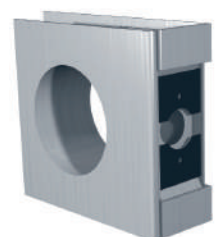
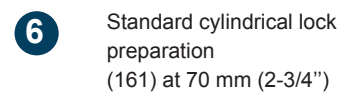
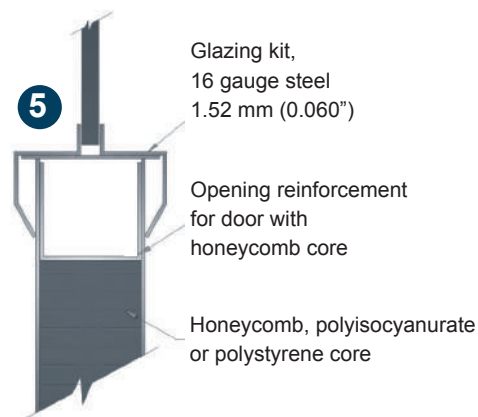
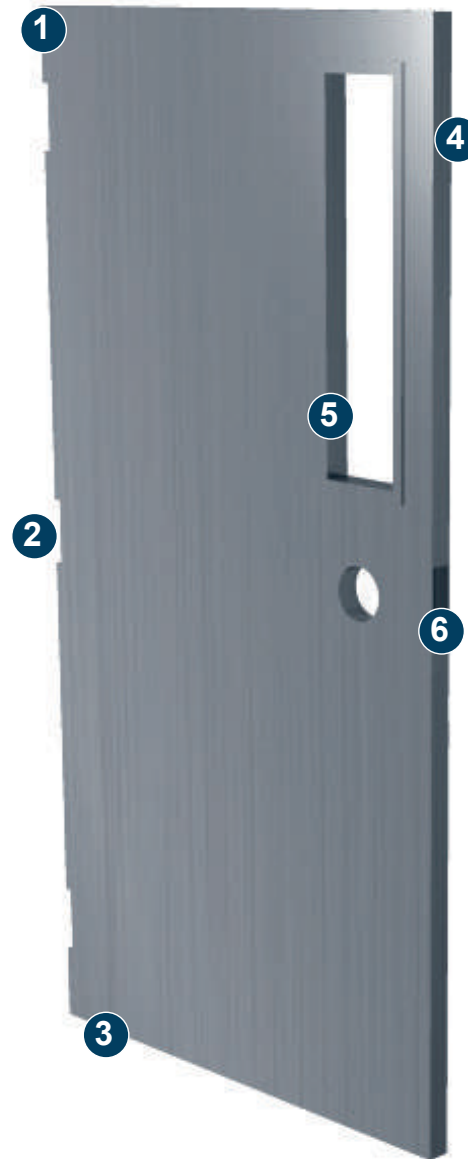
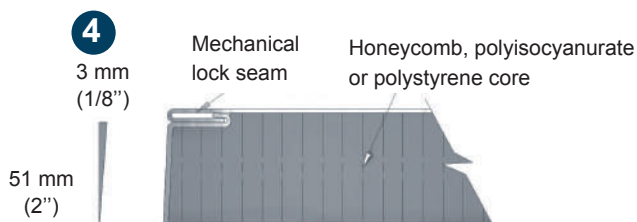
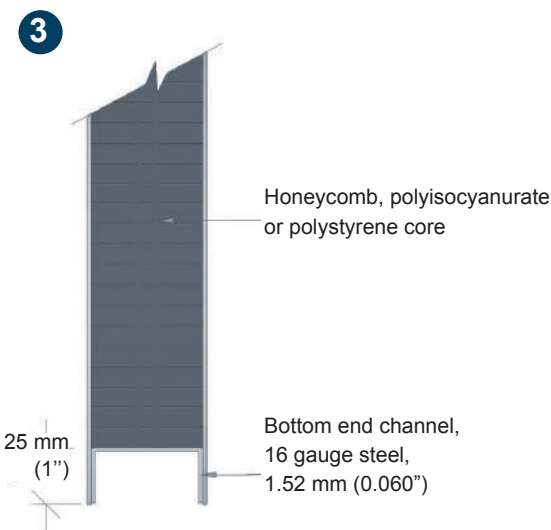
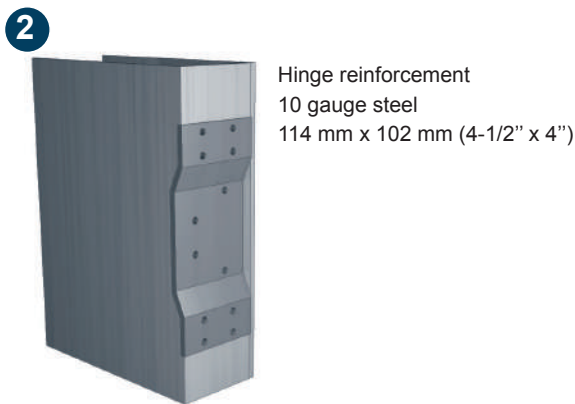
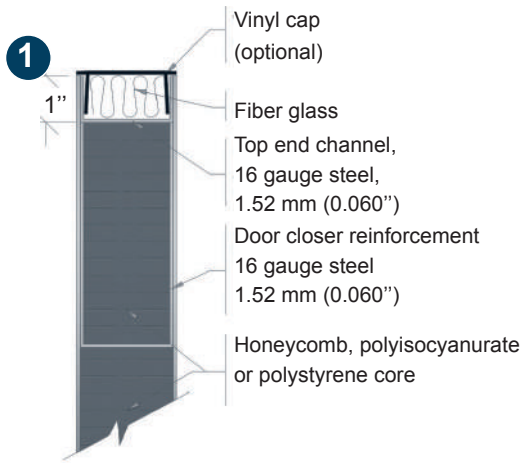

STEEL DOORS

STEEL DOORS

Opening types

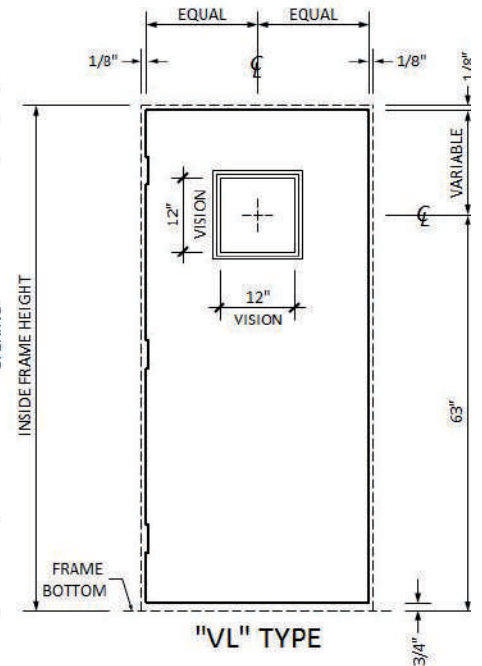
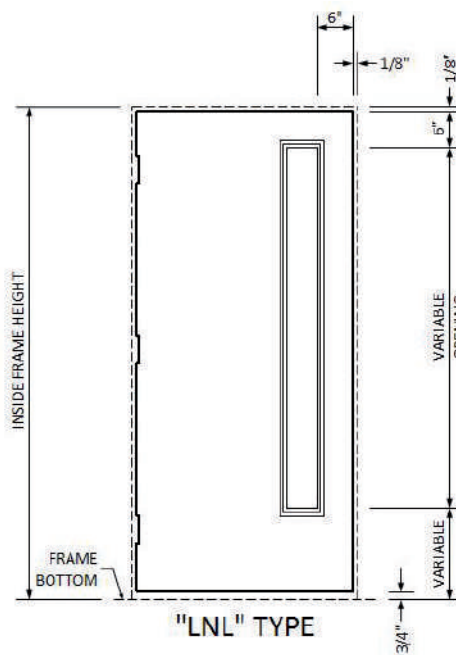
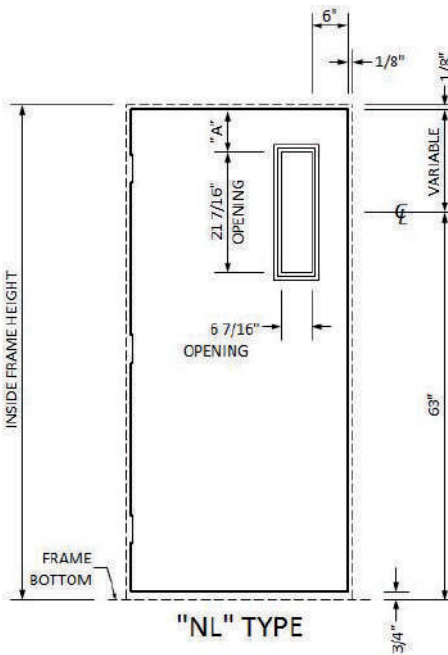
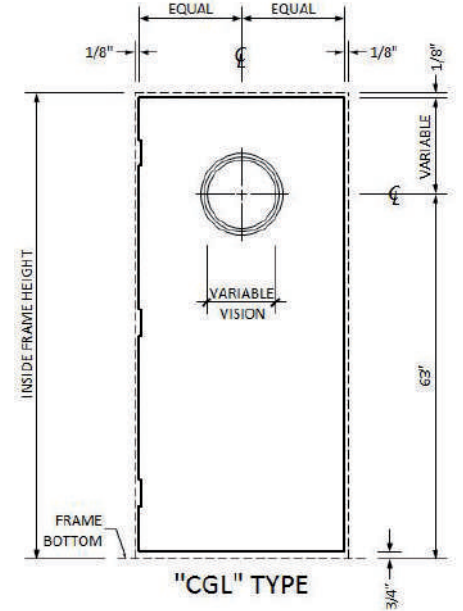
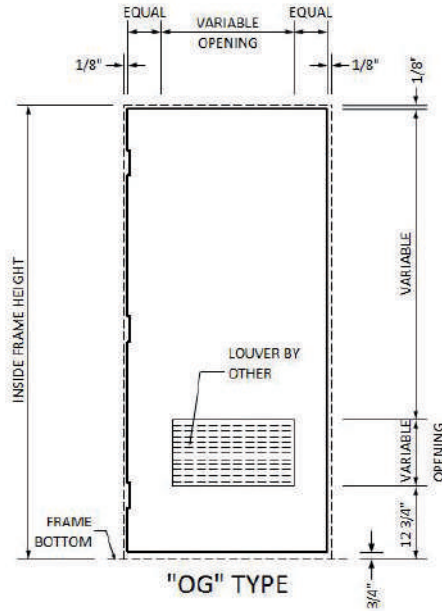
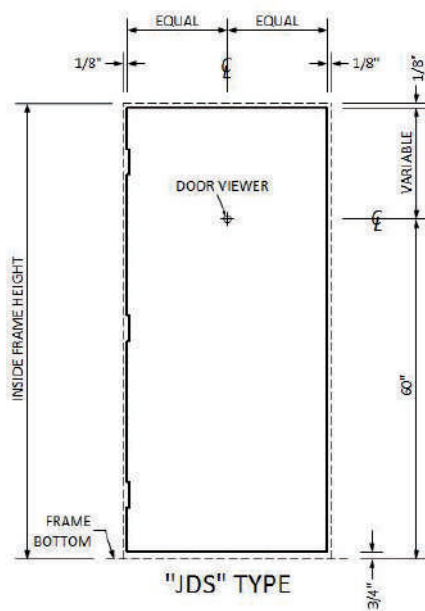

STEEL DOORS

Opening types (continued)

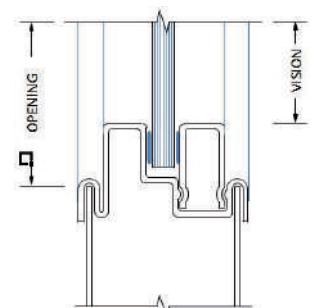
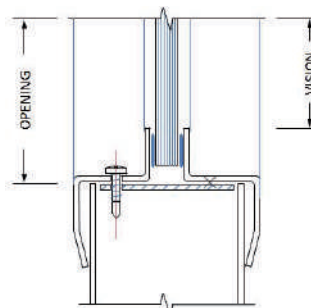
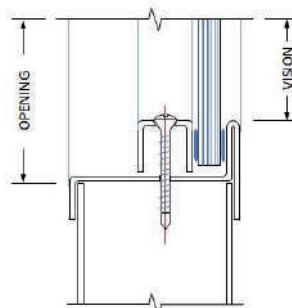
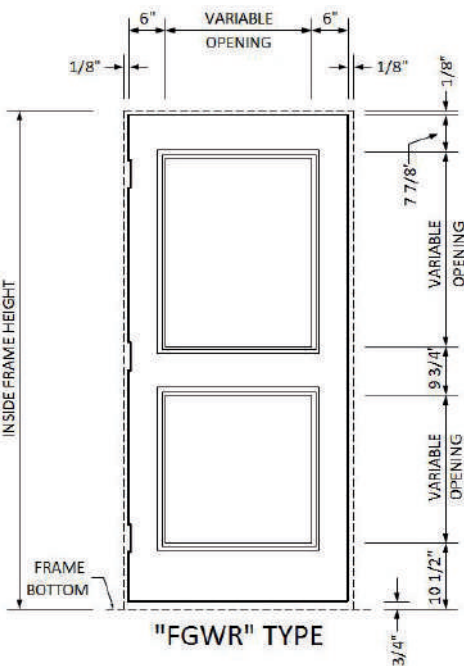
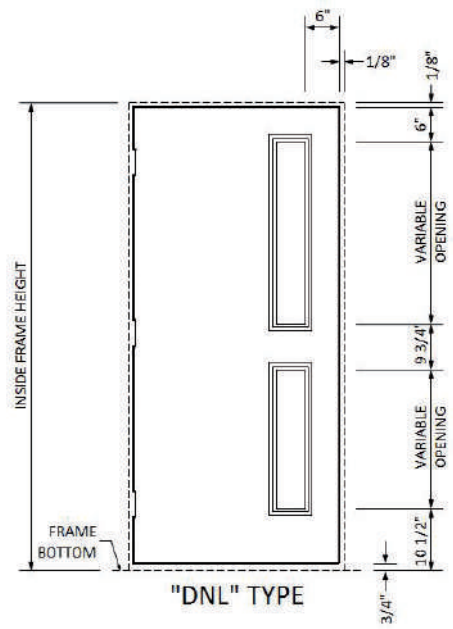
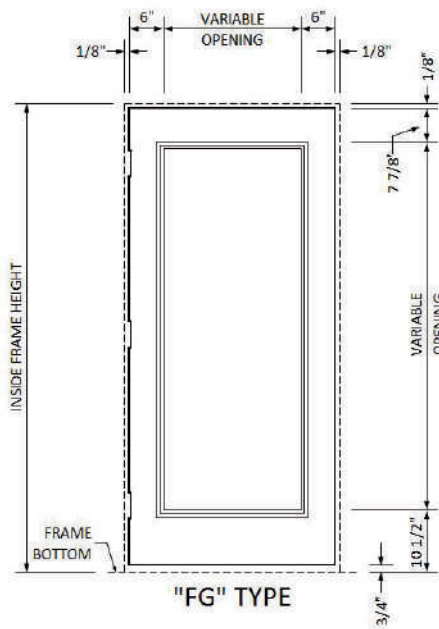
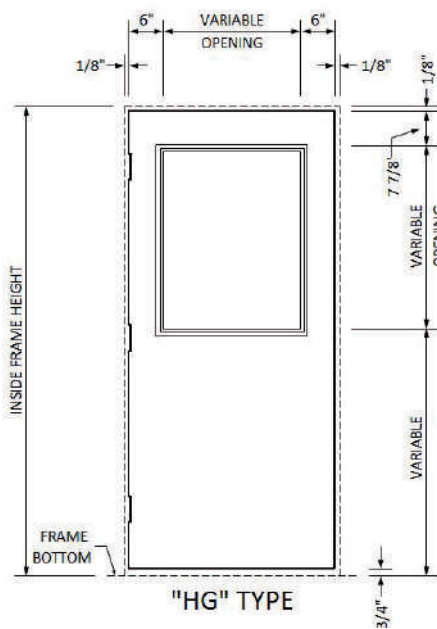

"TH" and "KM" available for 1/4" to 1" thick glass
 "SI" available for 1/4" thick glass only