

Steel doors

Over the years, Métalec has established a solid reputation in the steel door manufacturing area of expertise for commercial, industrial and institutional purposes.

The Métalec steel doors are offered in several sizes with a variety of designs and cores. They are also available with a 20, 45, 90, or 180 min. fire rating. A label is affixed on the product to certify the fire resistance period.

"PRV" SERIES

Technical details

- Heavy duty doors from the "PRV" series are available in 18, 16 and 14 gauge steel;
- These doors are designed to withstand high frequency use. They have been used in schools, hospitals, detention centres and recreational buildings;
- Using essentially the same manufacturing process as the "PS" series, these doors have vertical 20, 18 or 16 gauge steel reinforcements bonded to the door faces at every 152 mm (6") on center, or welded when a fire rated certification is required;
- The voids between the vertical reinforcements can be filled with polyisocyanurate, polystyrene, honeycomb kraft paper or a fiberglass insulating material;
- The door faces are assembled vertically one to each other by a mechanical lock seam with flush welding near the hardware perforations.

Options

- The door faces are vertically assembled one to each other by a fully welded joint on each side and ground smooth.
- A 14 gauge steel vertical channel reinforcement is welded at the joint on each side to strengthen the assembly. A primer is applied all over the joint.

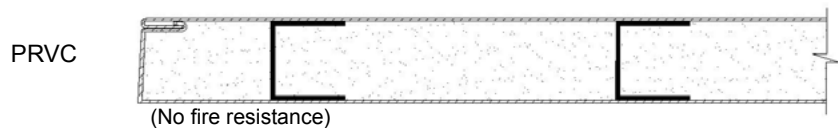
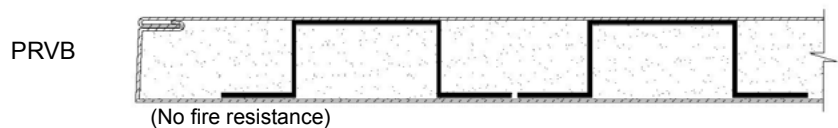
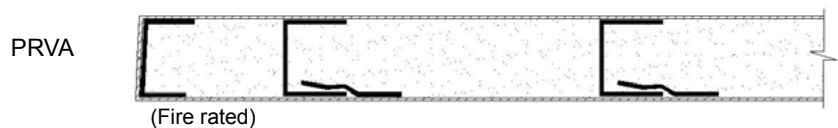

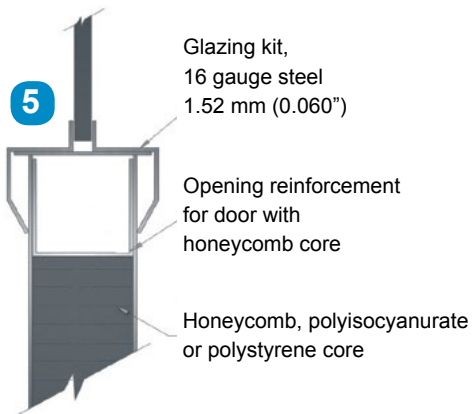
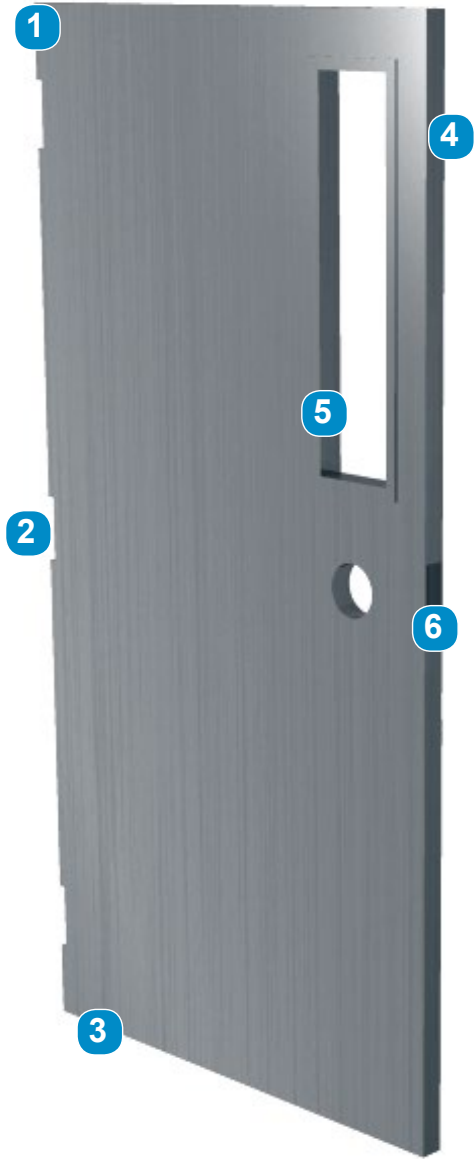
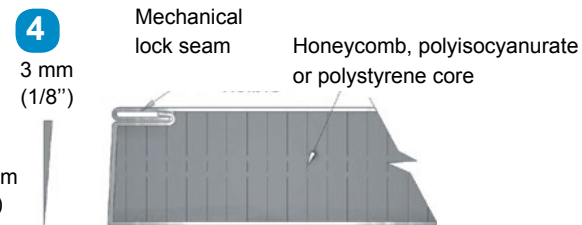
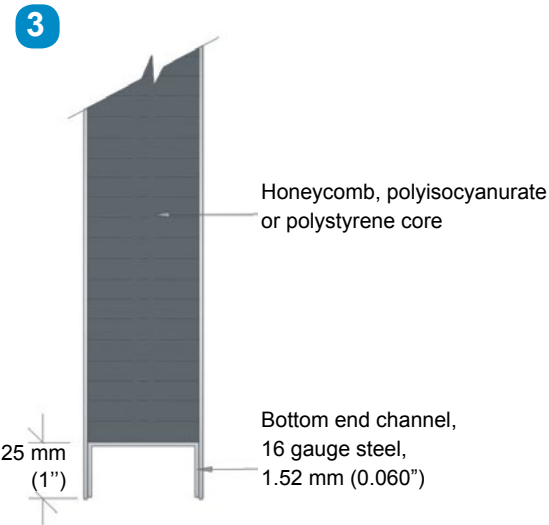
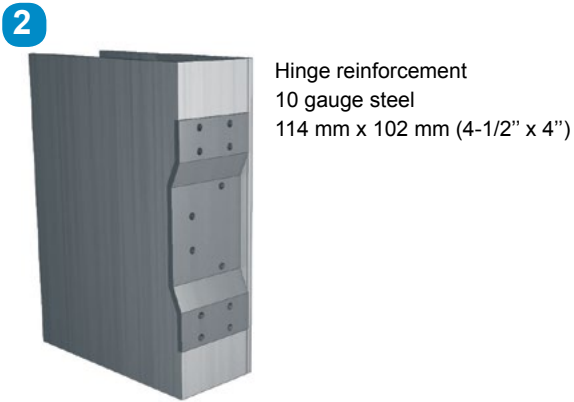
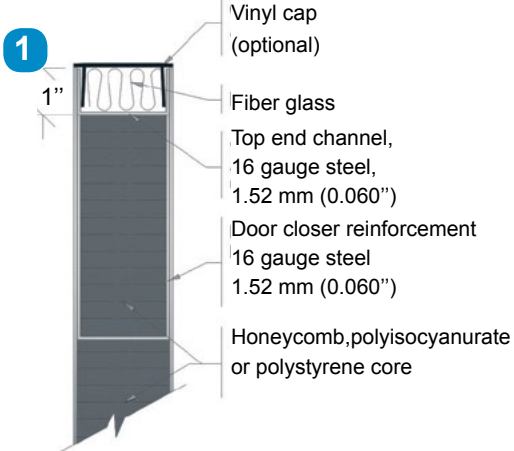

6 Standard cylindrical lock preparation (161) at 70 mm (2-3/4")



Steel doors

STEEL DOORS

Options

- All of these designs are also available in Z275 (G90) galvanized steel;
- Vinyl caps installed at the top of the doors for exterior openings;
- Steel caps installed at the top and the bottom of the doors;
- Mechanical lock seams welded at every 152 mm (6") center to center grinded, filled with metallic paste, ground smooth and primed;
- Other hardware preparations are also available upon request.

Glazed openings

MAXIMUM LIMITATIONS OF GLAZED OPENINGS IN FIRE DOORS

- 180 min. fire rated door (no glazing allowed)
- 90 min. fire rated door (max. 645 cm² (100 in²) per door)
- 45 min. fire rated door (max. 8361 cm² (1296 in²) per opening and max. dimensions 54")
- Several designs of doors with glazed openings are available and Métalec offers you different trim kits:

"NL" - "LNL" - "DNL" - "HG" - "FGWR" - "VL" - "CGL" - "FG" - "JDS" - "OG" type
(See Glazed opening types hereafter)

STEEL DOORS

Opening types

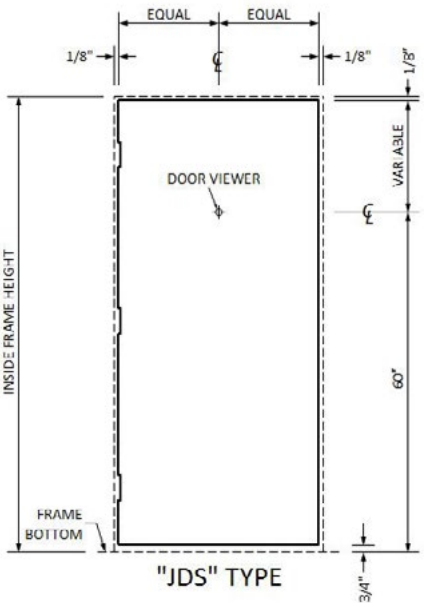

"JDS" TYPE

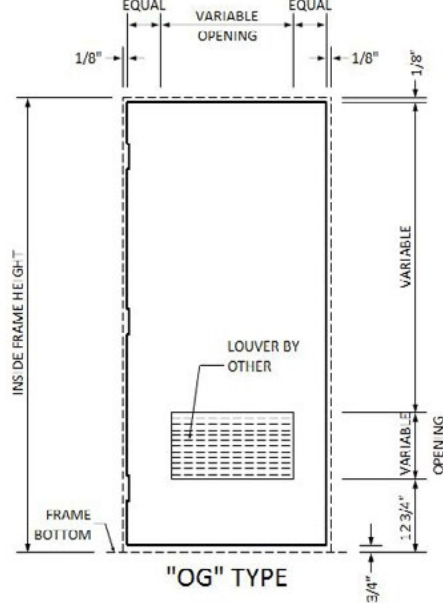

"OG" TYPE

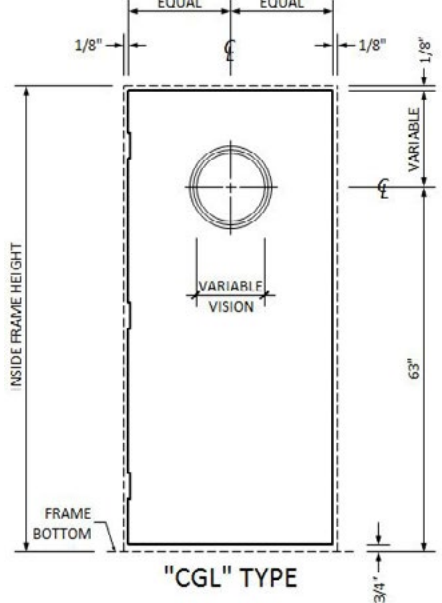

"CGL" TYPE

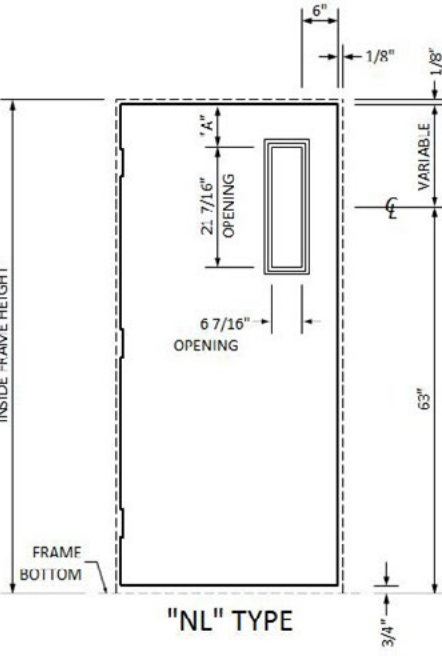

"NL" TYPE

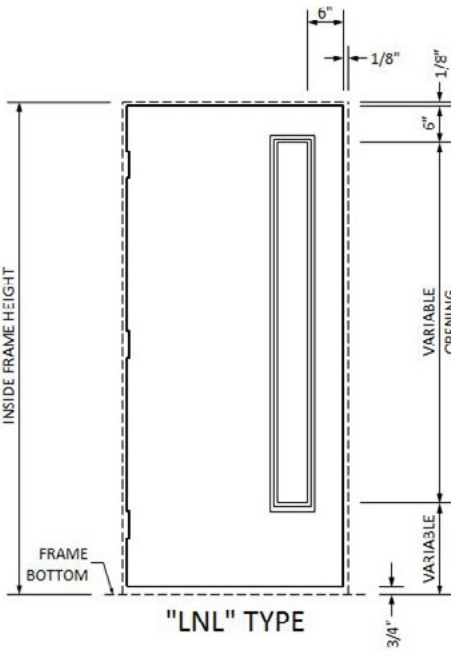

"LNL" TYPE

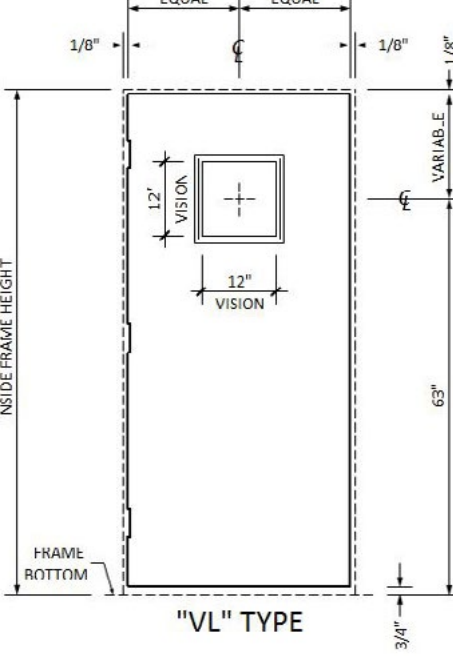

"VL" TYPE

Steel doors

STEEL DOORS

Opening types (continued)

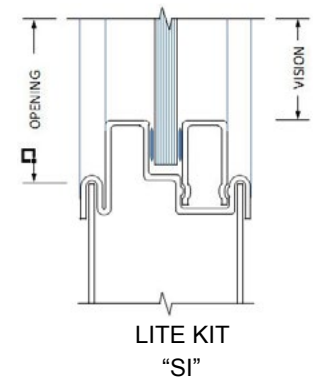
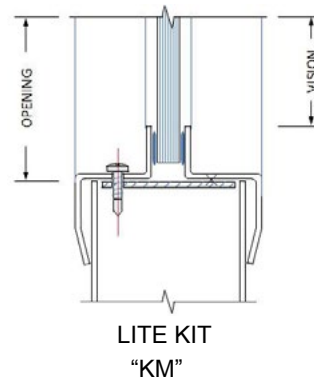
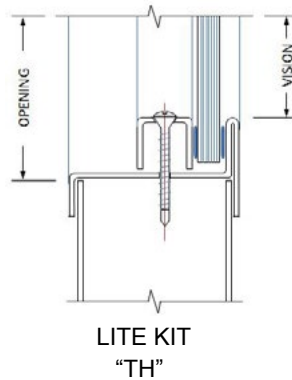
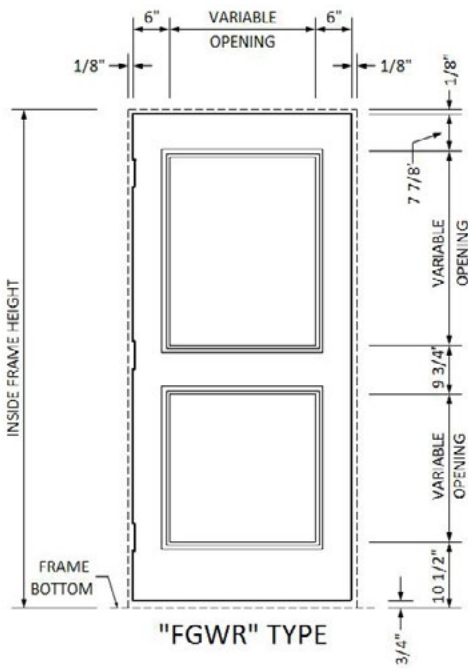
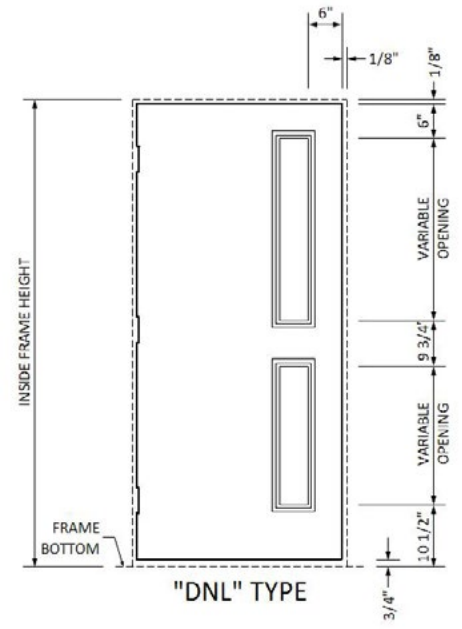
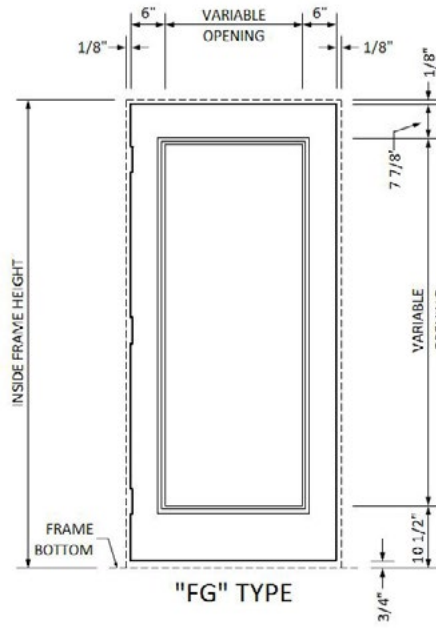
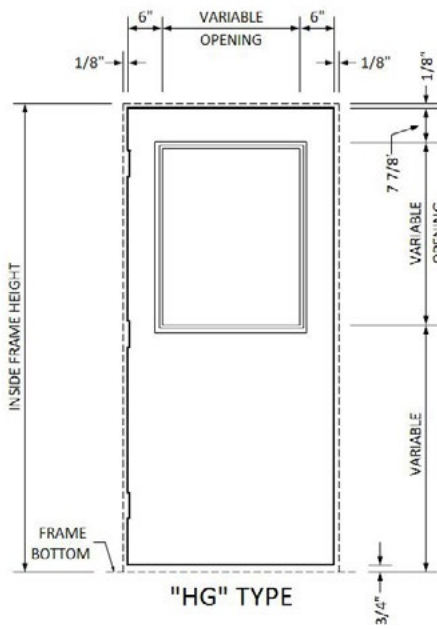

"TH" and "KM" available for 1/4" to 1" thick glass
 "SI" available for 1/4" thick glass only